

DRAWING FOR APPROVAL

PLEASE RETURN THIS DRAWING WITH YOUR COMPANY STAMP, SIGNATURE AND DATE. AFTER YOUR APPROVAL WE WILL BE PROCEEDING WITH SUPPLIES AND PRODUCTION.

.....Signe

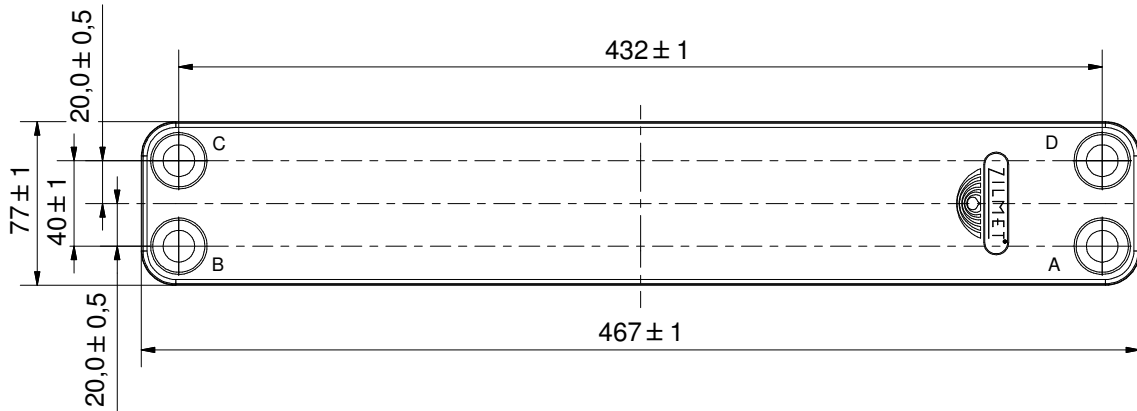
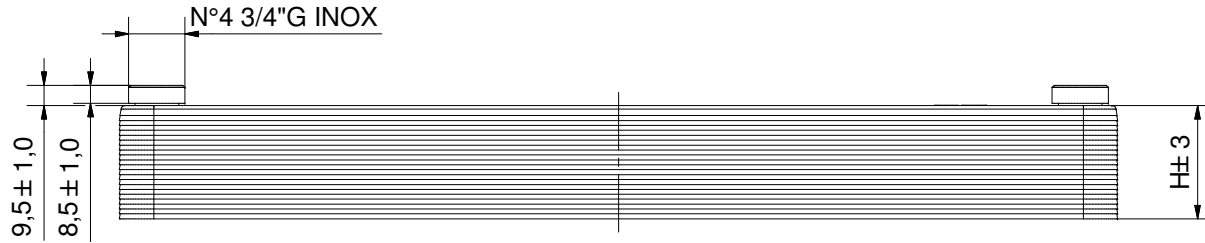

CIRCOLAZIONE FLUIDI CIRCUITO PRIMARIO ENTRATA IN C - USCITA IN D (PRIMARY CIRCUIT IN C - OUT D)
CIRCUITO SECONDARIO ENTRATA IN A - USCITA IN B (SECONDARY CIRCUIT SANITARY IN A - OUT B)

Pressione max esercizio (Max operating pressure): 30 bar
 Circuito Primario (Primary circuit): 30 bar
 Circuito secondario (Secondary circuit): 30 bar
 Temperatura esercizio (Max operating temperature): -50/+200°C
 Materiale (Material): INOX AISI 316L
 Materiale di brasatura (Brazing material): 99.9% Cu

CODE	N° PLATES	H (mm)
17B3501004	10	31
17B3502004	20	52
17B3502404	24	61
17B3503004	30	74
17B3504004	40	95
17B3505004	50	117
17B3506004	60	138
17B3508004	80	181

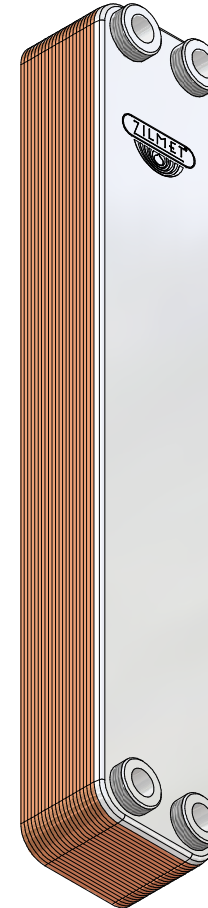

REV	DESCRIZIONE	DATA
00	Issued for construction - Preliminary	23/01/2014
01	Height dimensions	25/05/2015

 35010 Limena (PD) Via del Santo 242 tel.049/8840662	DRAWING N°	SCALE	
	ZB 350		
Denomination SCAMBIATORE DI CALORE SALDOBASATO (BRAZED HEAT EXCHANGERS)	Drawn	Date	Signature
	GIBIN G.	25/05/2015	
	Checked	Date	Signature
	PIROVANO M.	25/05/2015	
Approved	Date	Signature	
S.R.I. BENETTOLO	25/05/2015		

CODE	17B350--04
This drawing is property of company ZILMET S.p.a. All rights reserved.	