

**6-kt.\* Reduzierstück**  
**Hexagon bushing**

**Innen- / Außengewinde / female / male thread**  
**Material 1.4408 (AISI 316) V4A**

**325**

Rohranschlussmaß	Gewicht
Nominal Pipe Size	Weight

(NPS)	L	SW	kg	Artikelnummer	
				Item No.	
1/4" - 1/8"	16,5	14,4	0,0080	325014018T	■
3/8" - 1/8"	17,0	18,0	0,0150	325038018T	■
3/8" - 1/4"	17,0	18,0	0,0128	325038014T	■
1/2" - 1/8"	20,0	21,5	0,0270	325012018T	■
1/2" - 1/4"	20,0	21,5	0,0250	325012014T	■
1/2" - 3/8"	20,0	21,5	0,0200	325012038T	■
3/4" - 1/8"	23,5	27,5	0,0560	325034018T	■
3/4" - 1/4"	23,5	27,5	0,0540	325034014T	■
3/4" - 3/8"	23,5	27,5	0,0440	325034038T	■
3/4" - 1/2"	23,5	27,5	0,0370	325034012T	■
1" - 1/8"	25,0	34,5	0,1040	325100018T	■
1" - 1/4"	25,0	34,5	0,0800	325100014T	■
1" - 3/8"	25,0	34,5	0,0710	325100038T	■
1" - 1/2"	25,0	34,5	0,0690	325100012T	■
1" - 3/4"	25,0	34,5	0,0520	325100034T	■
1 1/4" - 1/8"	28,5	43,5	0,1600	325114018T	■
1 1/4" - 1/4"	28,5	43,5	0,1550	325114014T	■
1 1/4" - 3/8"	28,5	43,5	0,1500	325114038T	■
1 1/4" - 1/2"	28,5	43,5	0,1290	325114012T	■
1 1/4" - 3/4"	28,5	43,5	0,1310	325114034T	■
1 1/4" - 1"	28,5	43,5	0,1500	325114100T	■
1 1/2" - 1/4"	29,0	49,0	0,2090	325112014T	■
1 1/2" - 3/8"	29,0	49,0	0,2080	325112038T	■
1 1/2" - 1/2"	29,0	49,0	0,1800	325112012T	■
1 1/2" - 3/4"	29,0	49,0	0,1595	325112034T	■
1 1/2" - 1"	29,0	49,0	0,1660	325112100T	■
1 1/2" - 1 1/4"	29,0	49,0	0,1175	325112114T	■
2" - 1/4"	33,5	62,0	0,1870	325200014T	■
2" - 3/8"	33,5	62,0	0,3350	325200038T	■
2" - 1/2"	33,5	62,0	0,3145	325200012T	■
2" - 3/4"	33,5	62,0	0,3180	325200034T	■
2" - 1"	33,5	62,0	0,3130	325200100T	■
2" - 1 1/4"	33,5	62,0	0,2450	325200114T	■
2" - 1 1/2"	33,5	62,0	0,1950	325200112T	■
2 1/2" - 1/2"	36,5	78,0	0,5760	325212012T	○
2 1/2" - 3/4"	36,5	78,0	0,5593	325212034T	○
2 1/2" - 1"	36,5	78,0	0,5430	325212100T	■
2 1/2" - 1 1/4"	36,5	78,0	0,5160	325212114T	■
2 1/2" - 1 1/2"	36,5	78,0	0,5000	325212112T	■
2 1/2" - 2"	36,5	78,0	0,3770	325212200T	■
3" - 1/2"	42,5	90,0	0,8115	325300012T	■
3" - 3/4"	42,5	90,0	0,7956	325300034T	■
3" - 1"	42,5	90,0	0,7800	325300100T	■

\* AB 1" 8-kt. Ausführung

Alle Maße in mm / All sizes in mm  
Technische Änderungen vorbehalten / Technical changes reserved

■ Standard-Lagerartikel / warehouse stock ○ Auftragsbezogene Fertigung / order related production

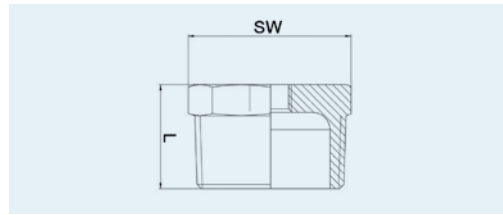

**6-kt.\* Reduzierstück**  
**Hexagon bushing**

**Innen- / Außengewinde / female / male thread**  
**Material 1.4408 (AISI 316) V4A**

**325**

Rohranschlussmaß	Gewicht
Nominal Pipe Size	Weight

(NPS)	L	SW	kg	Artikelnummer	
				Item No.	
3" - 1 1/4"	42,5	90,0	0,8480	325300114T	■
3" - 1 1/2"	42,5	90,0	0,7650	325300112T	■
3" - 2"	42,5	90,0	0,6826	325300200T	■
3" - 2 1/2"	42,5	90,0	0,4350	325300212T	■
4" - 1/2"	45,0	115,0	1,7140	325400012T	○
4" - 3/4"	45,0	115,0	1,6970	325400034T	○
4" - 1"	45,0	115,0	1,6803	325400100T	■
4" - 1 1/4"	45,0	115,0	1,6754	325400114T	■
4" - 1 1/2"	45,0	115,0	1,6700	325400112T	■
4" - 2"	45,0	115,0	1,4400	325400200T	■
4" - 2 1/2"	45,0	115,0	1,1850	325400212T	■
4" - 3"	45,0	115,0	0,9780	325400300T	■

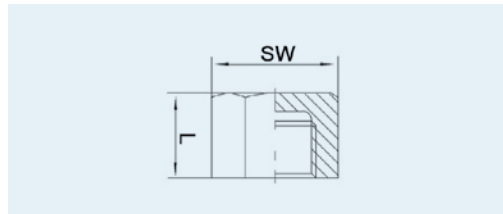
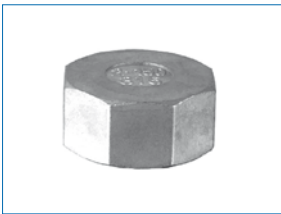

**6-kt.\* Kappe**  
**Hexagon cap**

**Material 1.4408 (AISI 316) V4A**

**326**

Rohranschlussmaß	Gewicht
Nominal Pipe Size	Weight

(NPS)	SW	L	kg	Artikelnummer	
				Item No.	
1/8"	14,0	15,0	0,0105	326018T	■
1/4"	16,5	18,0	0,0190	326014T	■
3/8"	20,0	20,0	0,0235	326038T	■
1/2"	25,0	18,5	0,0400	326012T	■
3/4"	30,5	19,0	0,0600	326034T	■
1"	37,0	22,0	0,0805	326100T	■
1 1/4"	45,5	25,0	0,1170	326114T	■
1 1/2"	52,5	25,0	0,1635	326112T	■
2"	64,5	30,0	0,2943	326200T	■
2 1/2"	80,5	34,5	0,4390	326212T	■
3"	94,0	38,5	0,6300	326300T	■
4"	120,0	45,5	1,0950	326400T	■

\* AB 1" 8-kt. Ausführung

Alle Maße in mm / All sizes in mm  
Technische Änderungen vorbehalten / Technical changes reserved

■ Standard-Lagerartikel / warehouse stock    ○ Auftragsbezogene Fertigung / order related production