

Adaptor kit
SERIE 900C
CENTRA DR, ZR, DRG, DRR, DRU

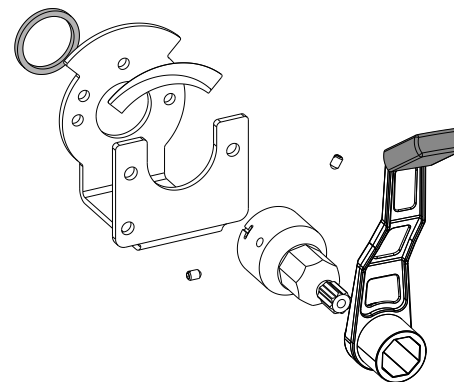

 SERIE 90	 SERIE CRA120
 SERIE 90C	 SERIE CRC120
 ADAPTER KIT 900C	
	CENTRA DR DN 15-50 ZR DN 15-50 DRG DN 15-50 DRU DN 25-32 DRR DN 25-32

Mtrl.nr: 9814 04 25 • Ritn.nr: 4708 utg. D • Rev. 2020-11-10

i

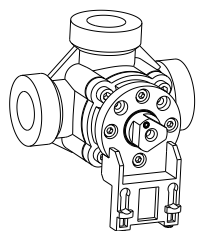
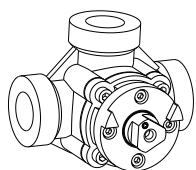

1

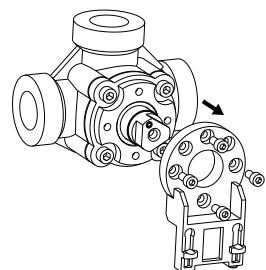
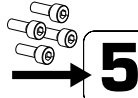
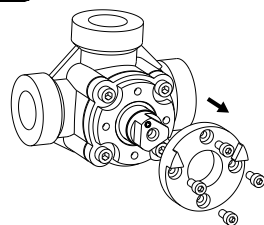

2

CENTRA **DRR, DRU**

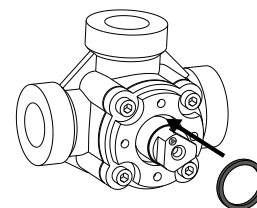

CENTRA **ZR, DRG**

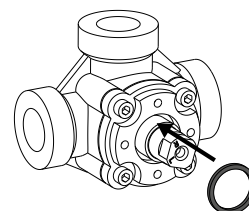

3

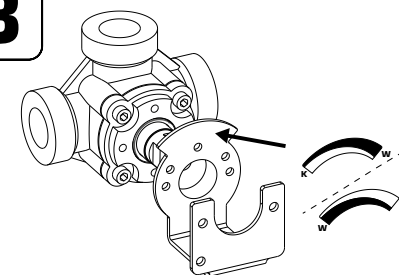

4

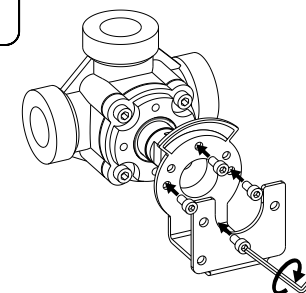

5

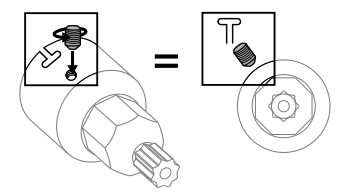
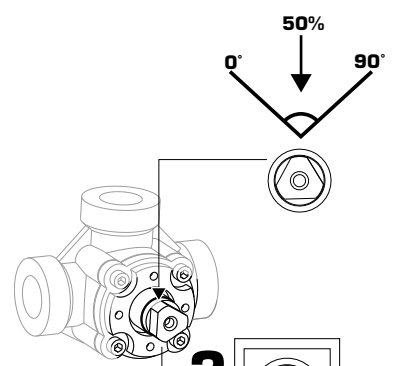

CENTRA DR, DRG, ZR

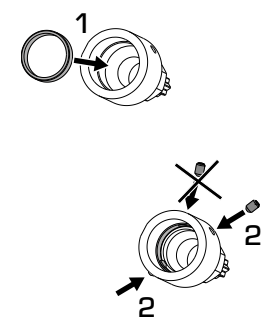

i 5a-5g

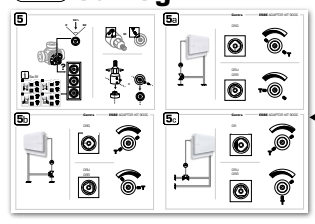

5a

Centra ESBE ADAPTOR KIT 900C

All piping schematics are general representations



DRG

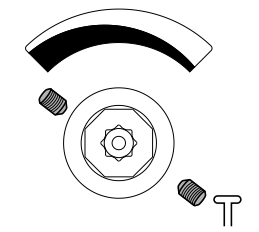
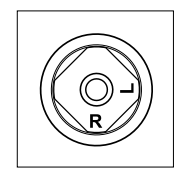

DRU
DRR

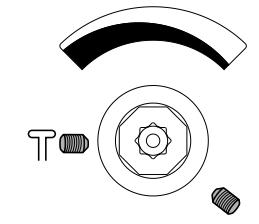
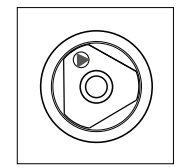

5b

Centra ESBE ADAPTOR KIT 900C



DRG

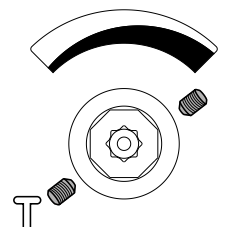
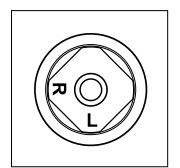

DRU
DRR

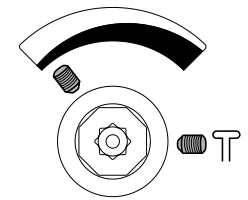
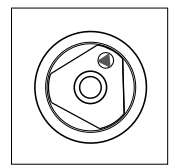

5c

Centra ESBE ADAPTOR KIT 900C



DR

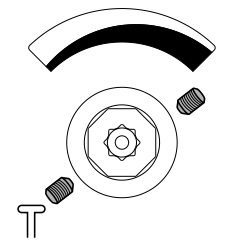
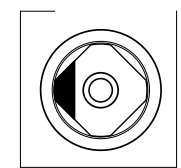

DRU
DRR

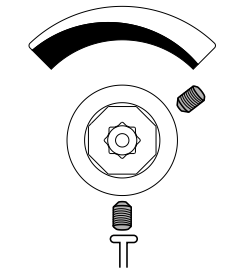
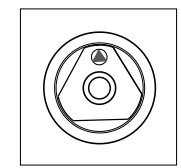

5d

Centra ESBE ADAPTOR KIT 900C

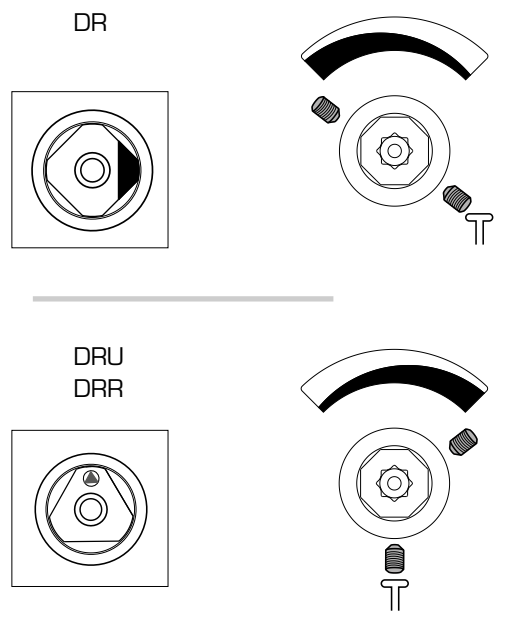
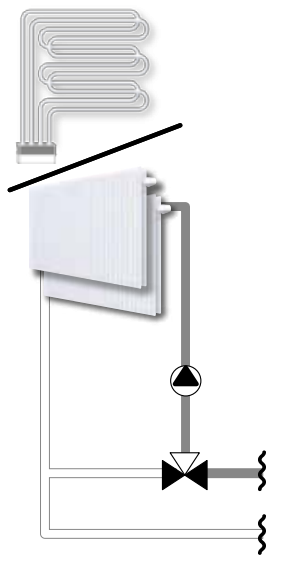

5e

Centra ESBE ADAPTOR KIT 900C

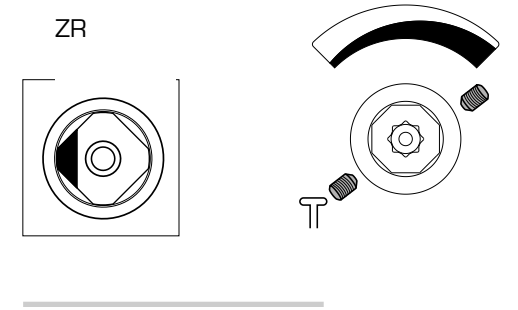

All piping schematics are general representations

5f

Centra ESBE ADAPTOR KIT 900C

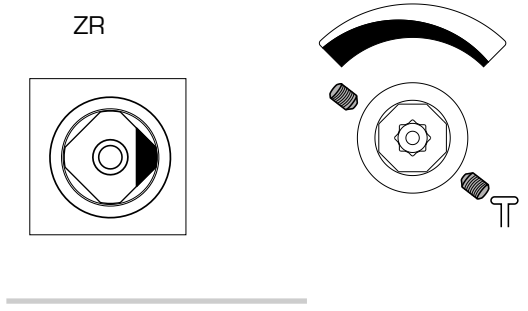
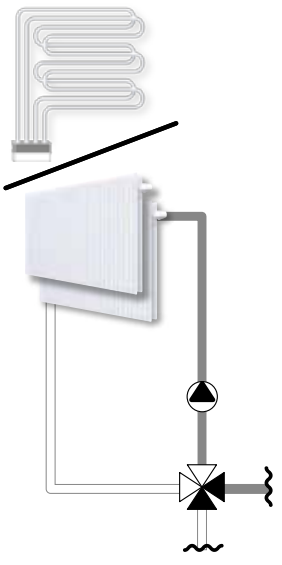

5g

Centra

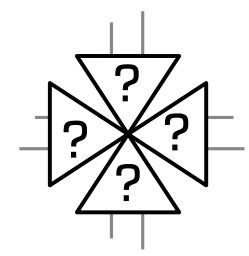

Product information card for Centra valves. It features a factory icon, an information icon (i), and a photograph of a valve. Below the photo, the text reads: **CENTRA**, DR, ZR, DRG, DRU, DRR.

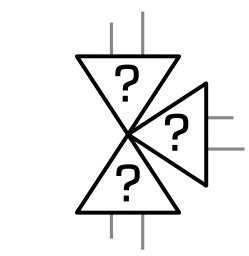

6

CENTRA DRR, DRU

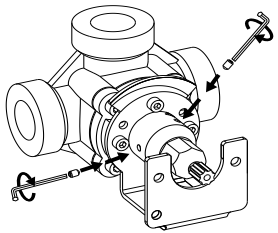

7

CENTRA ZR, DRG, DR

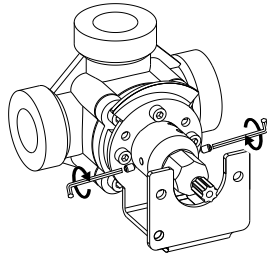

8

SERIES 90C

SERIES 90

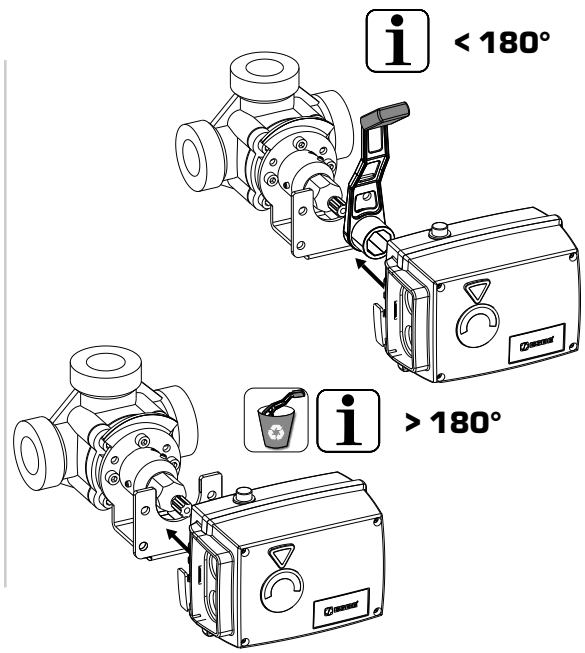
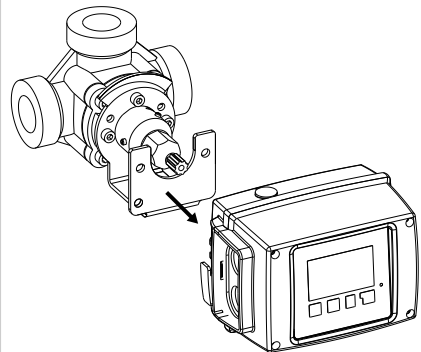
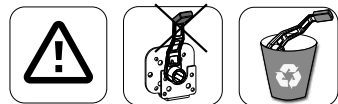

9

