

Anschweißnippel Welding Nipple

ähnlich / analog to DIN EN 10241:2000 (alte / old DIN2982)
 Material 1.4408 (AISI 316) V4A

30816

Rohranschlussmaß		Gewicht			
Nominal Pipe Size		Weight			
(NPS)	Ø	L	kg	Artikelnummer	
				Item No.	
1/8"	10,2	30,0	0,0090	30816018T	○
1/4"	14,0	30,0	0,0150	30816014T	■
3/8"	17,0	30,0	0,0200	30816038T	■
1/2"	21,5	35,0	0,0310	30816012T	■
3/4"	26,8	40,0	0,0600	30816034T	■
1"	34,0	40,0	0,0725	30816100T	■
1 1/4"	42,7	50,0	0,1350	30816114T	■
1 1/2"	48,8	50,0	0,1325	30816112T	■
2"	61,0	50,0	0,2070	30816200T	■
2 1/2"	77,5	60,0	0,4500	30816212T	■
3"	90,0	70,0	0,6300	30816300T	■
4"	115,8	80,0	1,0400	30816400T	■

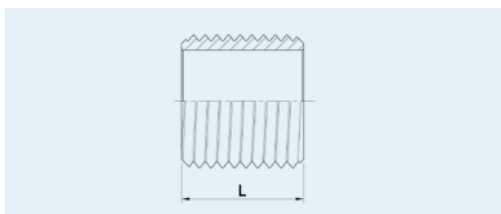

Rohnippel Running Nipple

hergestellt aus geschweißtem Rohr
 made from welded tubes
 ähnlich / analog to DIN EN 10241:2000 (alte / old DIN 2982)
 Material 1.4571

309

Rohranschlussmaß		Gewicht			
Nominal Pipe Size		Weight			
(NPS)	L	kg	Artikelnummer		
				Item No.	
1/8"	16,0	0,003	309018T	■	
1/4"	18,0	0,005	309014T	■	
3/8"	22,0	0,009	309038T	■	
1/2"	25,0	0,018	309012T	■	
3/4"	30,0	0,026	309034T	■	
1"	35,0	0,042	309100T	■	
1 1/4"	38,0	0,066	309114T	■	
1 1/2"	38,0	0,072	309112T	■	
2"	45,0	0,122	309200T	■	
2 1/2"	55,0	0,210	309212T	■	
3"	60,0	0,310	309300T	■	
4"	70,0	0,540	309400T	■	
5"	85,0	1,430	309500T	○	
6"	100,0	1,890	309600T	○	

Alle Maße in mm / All sizes in mm
 Technische Änderungen vorbehalten / Technical changes reserved

■ Standard-Lagerartikel / warehouse stock ○ Auftragsbezogene Fertigung / order related production

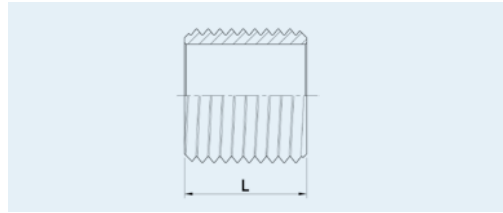
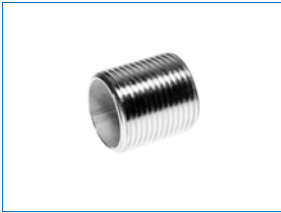

Rohnippel Running Nipple

hergestellt aus nahtlosem Rohr
made from seamless tubes
ähnlich / analog to DIN EN 10241:2000 (alte / old DIN 2982)
Material 1.4404 (AISI 316L) V4A

30904

Rohranschlussmaß		Gewicht		
Nominal Pipe Size		Weight		
(NPS)	L	kg	Artikelnummer	
			Item No.	
1/8"	16,0	0,003	30904018T	■
1/4"	18,0	0,005	30904014T	■
3/8"	22,0	0,009	30904038T	■
1/2"	25,0	0,018	30904012T	■
3/4"	30,0	0,026	30904034T	■
1"	35,0	0,042	30904100T	■
1 1/4"	38,0	0,066	30904114T	■
1 1/2"	38,0	0,072	30904112T	■
2"	45,0	0,122	30904200T	■
2 1/2"	55,0	0,210	30904212T	■
3"	60,0	0,310	30904300T	■
4"	70,0	0,540	30904400T	■
5"	85,0	1,430	30904500T	○
6"	100,0	1,890	30904600T	○

Alle Maße in mm / All sizes in mm
Technische Änderungen vorbehalten / Technical changes reserved

■ Standard-Lagerartikel / warehouse stock ○ Auftragsbezogene Fertigung / order related production